



嘉辉实业  
JIAHUI INDUSTRIAL

**嘉汇工业机械有限公司**

**Jiahui Industrial Machinery Co., Ltd.**

**Car Accessories Production Line**

Catalog  
2024







# Injection Molding Machine



The DK series has been developed to match the quality and performance of its European counterparts. Our aim is to be the first choice for even demanding sectors such as the automotive industry.

This has involved over 100 benchmarking tests and has resulted in 20+ unique patents. The result is a machine range with superior levels of productivity, accuracy and durability.



Automotive industry    Household electrical appliance industry    Deep cavity products    Large building and drainage products



# Injection Molding Machine

## DK Series Two Platen

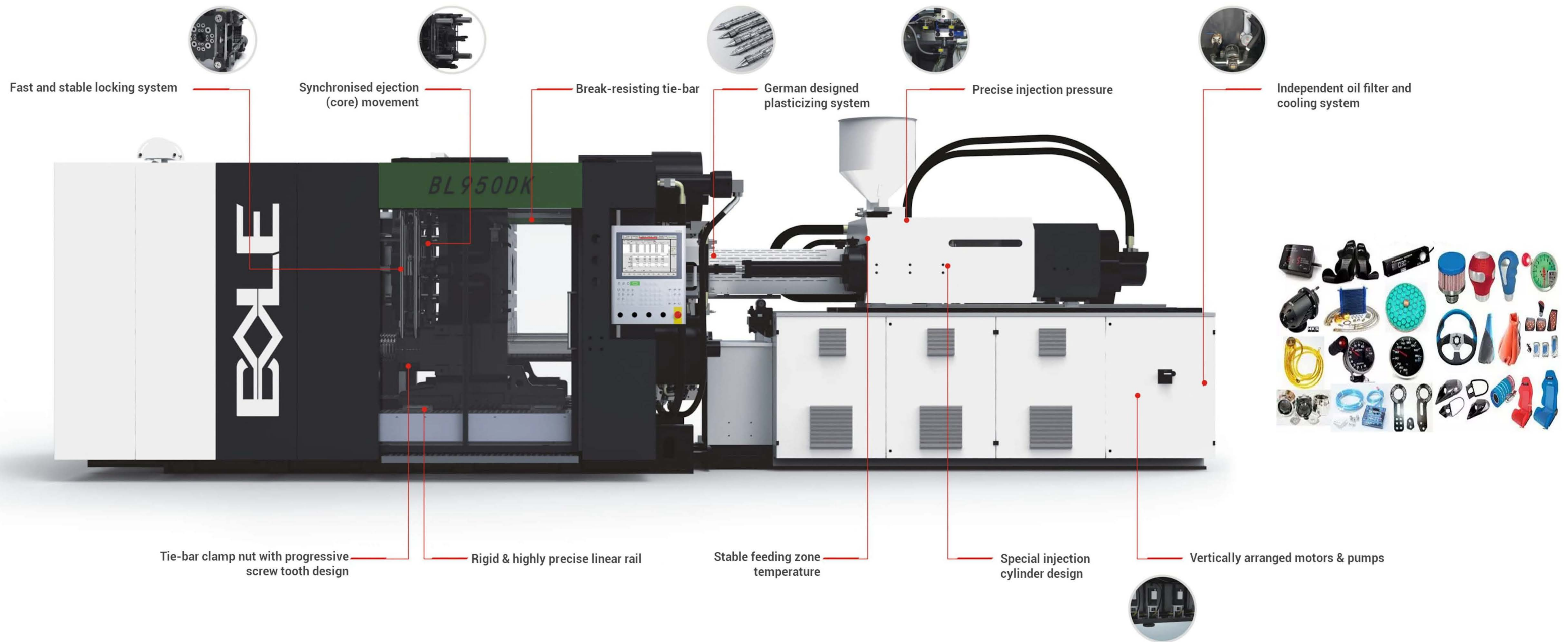



# Injection Molding Machine

## DK Series Two Platen - 11 Core Strengths

### 01 Break-resistant tie-bars

Patented design eliminates stress points and makes fracture extremely unlikely, even when the bar is overloaded or flexed.

### 02 Rigid & highly precise linear rails

DK series two-platen machines use linear guides to support the moving platen. This reduces friction and increases rigidity.

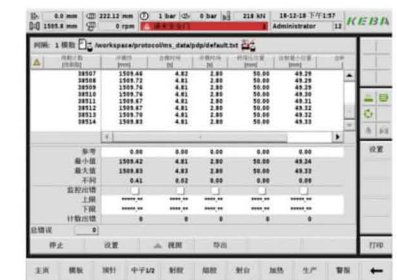
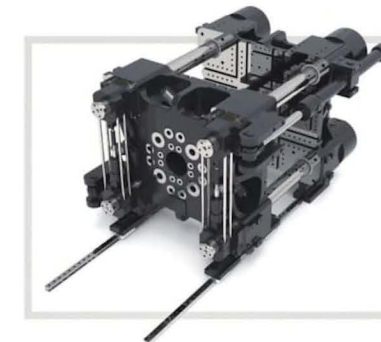
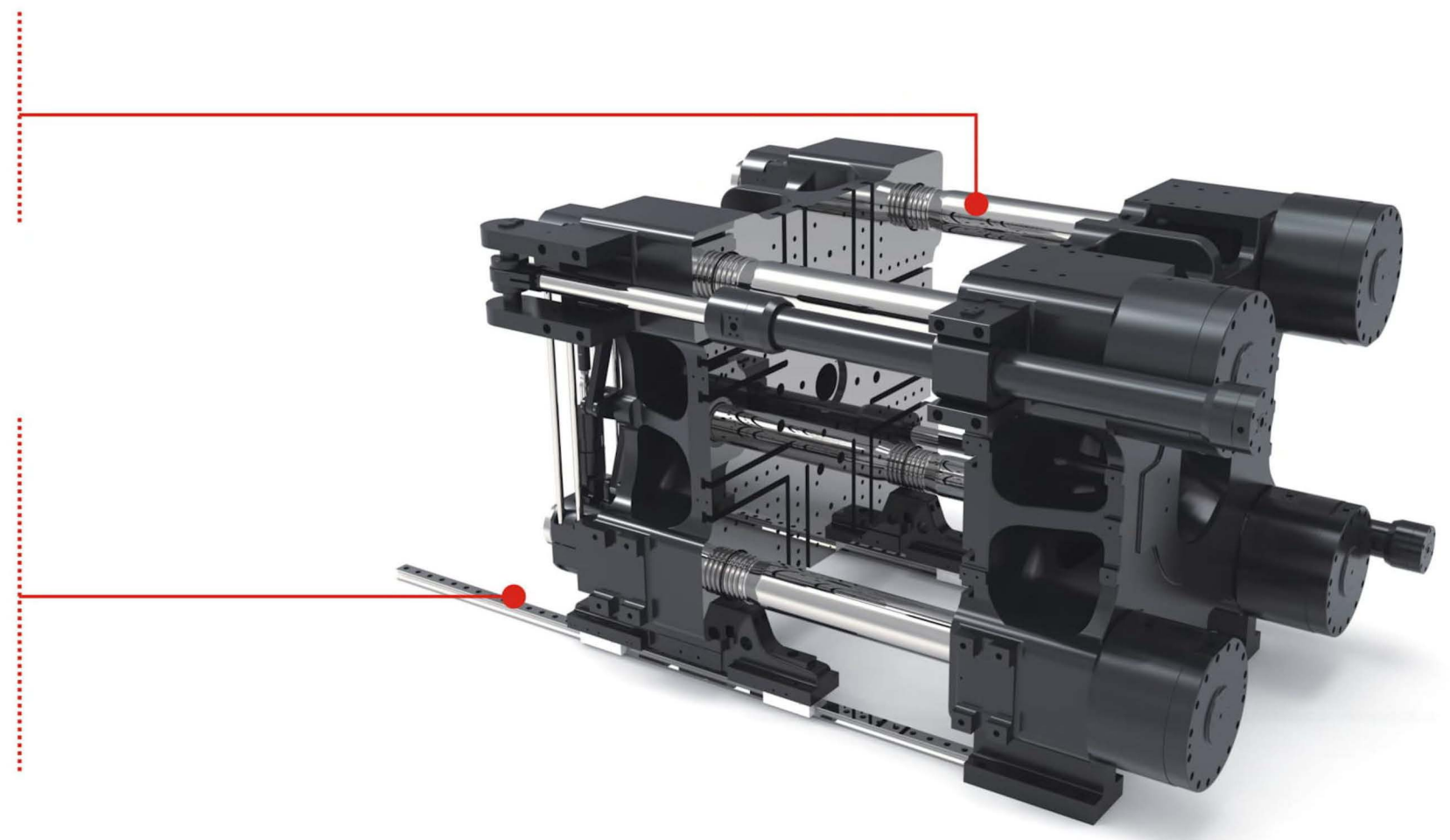



# Injection Molding Machine

## DK Series Two Platen - 11 Core Strengths



### 03 Plasticising Units

- Our design is based on German plasticising unit technology, providing efficiency levels that are at least 20% higher than typical for Chinese machines. (Based on common plastic grades, e.g. PP, PS and ABS).
- Technical and polymer specific solutions are also available
- All models can be supplied with A, B & C screw size options that have a 23:1 L/D ratio. This provides superior levels of processing efficiency and melt quality.

### 04 Vertically arranged motors & pumps

The vertical arrangement of the motor reduces the area occupied, and reduces the influence of the bias load caused by the gravity of the motor rotor. This improves the stability of the motor.



### 05 Fast and stable locking system

Our effective tie-bar locking system provides smooth and quiet operation, prolonging the serviceable life of both the bars and the mechanism itself.

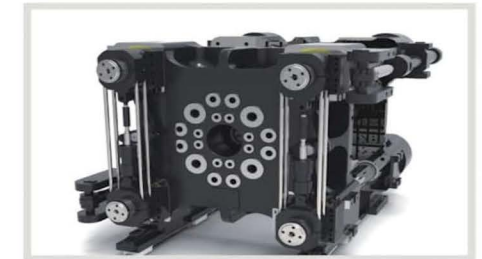

### 06 Synchronised ejection (core) movement

Simultaneous ejection (core) movement is provided as standard, shortening the overall cycle time by overlapping moulding phases.



### 07 Special injection cylinder design

The new design incorporates a low-pressure oil return system and dual linear guides that reduce friction and increase precision.





# Injection Molding Machine

## DK Series Two Platen - 11 Core Strengths

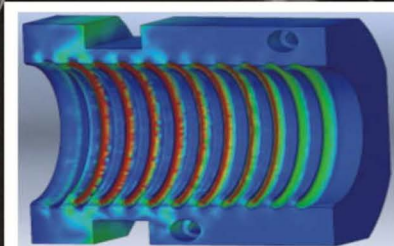
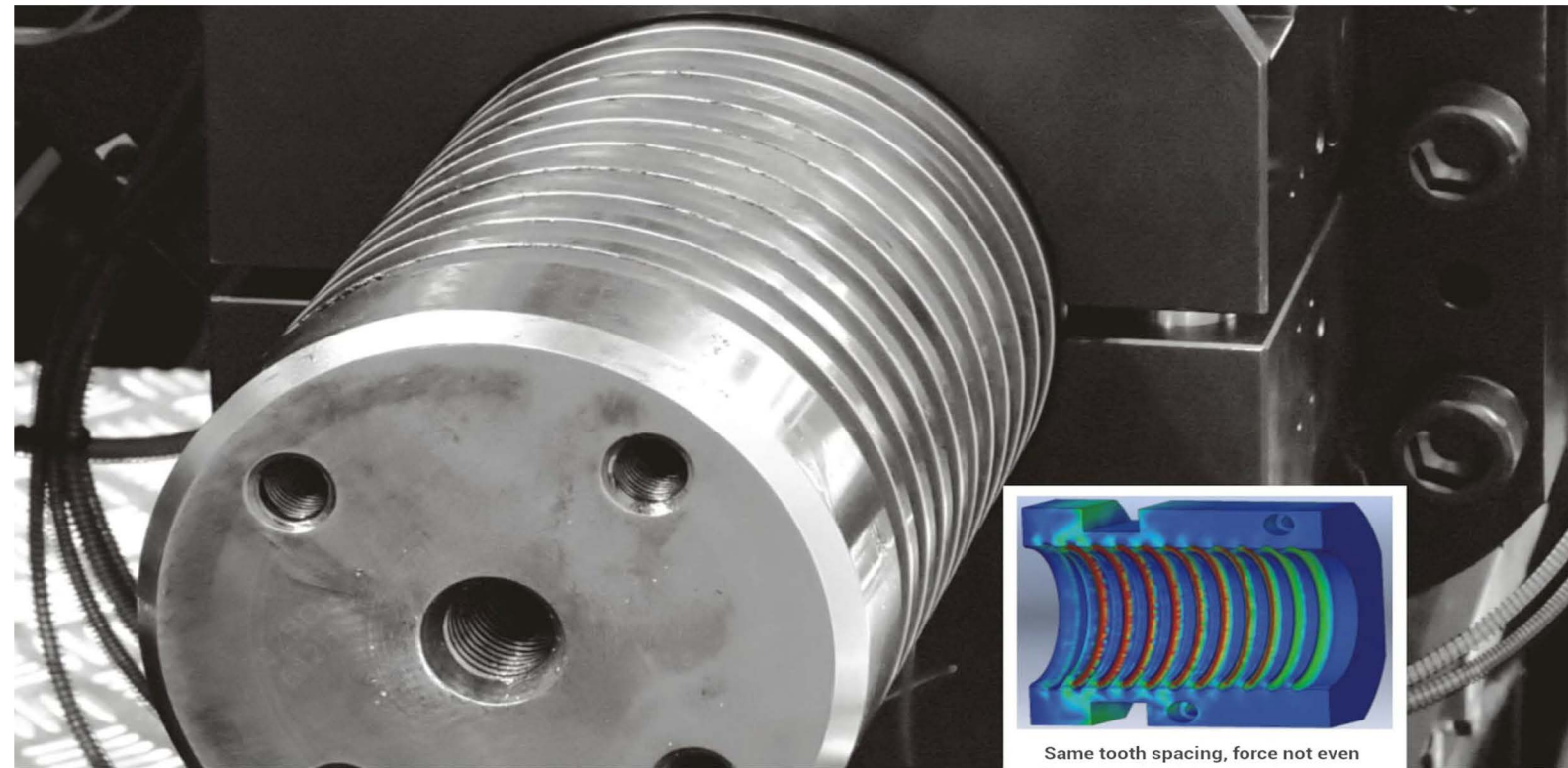

Same tooth spacing, force not even

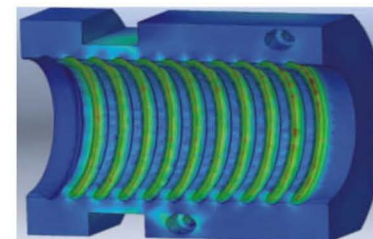

Variable tooth spacing, force even

### 08 Tie-bar clamping nut with progressive thread tooth design

Variable thread spacing is used to disperse stress (during the clamping phase) evenly across all teeth. This prolongs the serviceable life of both the nut and tie-bar.

### 09 Independent oil filter and cooling system

This provides a compact design that separates oil filtration and cooling away from the pressurised hydraulic system, therefore minimising any impact on cycle time etc.



German Technology · Made In China

### 10 Stable feeding zone temperature

The temperature of the machine's feed throat has a closed-loop control system, ensuring that material is fed into the injection unit consistently and without clogging. This improves throughput and product quality.



### 11 Control of injection pressure

Injection pressure is continually monitored, providing an accurate 'injection curve' that allows the process to be easily analysed and adjusted.

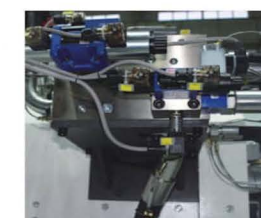



# Injection Molding Machine

## DK Series Two Platen

嘉汇工业机械有限公司  
Jiahui Industrial Machinery Co., Ltd.



Technical Data - Each tonnage is shown with typical injection unit size, but other options can be specified.

		BL520DK			BL620DK			BL750DK			BL950DK			BL1100DK			BL1400DK			BL1700DK			BL2000DK		
		BL520DK/Z2950			BL620DK/Z3700			BL750DK/Z4800			BL950DK/Z5900			BL1100DK/Z7900			BL1400DK/Z13400			BL1700DK/Z19300			BL2000DK/Z19300		
<b>Injection Unit</b>																									
Screw specification		Z2950			Z3700			Z4800			Z5900			Z7900			Z13400			Z19300			Z19300		
Screw diameter	mm	65	75	80	70	80	85	75	85	90	80	90	100	90	100	110	110	120	130	120	135	145	120	135	145
Screw L/D ratio		23	23	23	23	23	23	23	23	23	23	23	23	23	23	23	23	23	23	23	23	23	23	23	23
Calculated injection volume	cm <sup>3</sup>	1227	1634	1859	1596	2085	2354	2009	2581	2893	2513	3181	3927	3467	4280	5180	6082	7238	8495	8200	10378	11972	8200	10378	11972
Shot weight,PS	g	1129	1503	1710	1469	1918	2165	1848	2374	2662	2312	2926	3612	3189	3938	4765	5596	6659	7815	7544	9547	11014	7544	9547	11014
	oz	40	53	60	52	68	77	65	84	94	82	103	127	112	138	168	197	235	276	266	337	388	266	337	388
Injection piston speed	mm/s	116			119			116			106			104			105			102			102		
Injection rate	cm <sup>3</sup> /s	386	514	585	458	598	675	513	659	738	519	657	812	666	822	995	1038	1235	1450	1235	1563	1803	1235	1563	1803
	g/s	351	467	532	417	544	614	467	599	672	478	605	747	612	756	915	955	1136	1334	1136	1438	1659	1136	1438	1659
Injection pressure*	MPa	246	185	162	234	179	159	239	186	166	230	182	147	230	186	154	221	186	158	236	186	161	236	186	161
Screw speed	r/min	160			147			140			135			120			115			100			100		
<b>Clamping Unit</b>																									
Clamping force	Ton	531			633			765			969			1122			1429			1735			2041		
	kN	5200			6200			7500			9500			11000			14000			17000			20000		
Size of mould platens(h x v)	mm x mm	1260X1210			1380X1280			1500X1360			1560X1420			1855X1715			2130X2030			2260X2100			2480X2320		
Clearance between tie bars (h x v)	mm x mm	860X810			960X860			1060X920			1160X1020			1260X1120			1420X1320			1620X1460			1720X1560		
Opening stroke	mm	1100/600			1300/750			1400/800			1600/950			1870/1150			2200/1500			2570/1700			2580/1700		
Mould height min.	mm	350			350			400			450			480			650			680			720		
Mould height max.	mm	850			900			1000			1100			1200			1350			1550			1600		
Max. daylight	mm	1450			1650			1800			2050			2350			2850			3250			3300		
Ejector stroke	mm	250			250			280			280			320			360			400			450		
Ejector force forward	kN	124			124			232			232			232			309			309			465		
Ejector force backward	kN	75			75			155			155			155			210			210			310		
Number of ejector rods	PC	13			21			17			17			25			25			25			25		
<b>Driving and Heating</b>																									
Installed heating power	kW	22	25	22	28	33	37	32	38	42	37	42	56	42	56	72	72	75	87	75	96	115	75	96	115
Drive power	kW	30+42			42+42			50+30			50+30			50+30+21			50+50+50			50+50+42+42			50+50+42+42		
Working pressure	MPa	17.5			17.5			17.5			17.5			17.5			17.5			17.5			17.5		
<b>Other</b>																									
Oil tank capacity	L	600			800			900			1000			1400			2000			2500			2500		
Maximum mould weight	kg	6500			8000			9500			12000			15000			21000			35000			42000		
Net weight	ton	18			22			26			35			45			60			75			90		
Machine dimensions (LxWxH)	m x m x m	7.3X2.2X2.5			7.8X2.6X2.4			8.3X2.8X2.6			9.1X3.1X2.7			10.5X3.2X2.8			11.4X3.5X2.9			12.1X3.7X3.4			13.2X3.7X3.2		

Due to the continuous product improvement, we reserve the right to adjust the individual parameters, without notice.  
\*1 MPa is equivalent to 10 Bar

Due to the continuous product improvement, we reserve the right to adjust the individual parameters, without notice.  
\*1 MPa is equivalent to 10 Bar



# Injection Molding Machine

## DK Series Two Platen

嘉汇工业机械有限公司  
Jiahui Industrial Machinery Co., Ltd.



Technical Data - Each tonnage is shown with typical injection unit size, but other options can be specified.

		BL2300DK			BL2700DK			BL3000DK			BL3500DK			BL4000DK			BL5000DK			BL6800DK				
		BL2300DK/Z25800		BL2300DK/Z27300*	BL2700DK/Z36800		BL3000DK/Z36800		BL3500DK/Z58100		BL4000DK/Z79800		BL5000DK/Z79800		BL6800DK/Z119000									
<b>Injection Unit</b>																								
Screw specification		Z25800			Z27300*	Z36800			Z36800			Z58100		Z79800			Z79800			Z119000				
Screw diameter	mm	140	150	160	170	160	170	185	160	170	185	185	200	220	200	220	240	200	220	240	220	240	260	
Screw L/D ratio		23	23	23	22	23	23	23	23	23	23	23	23	23	23	23	23	23	23	23	23	23	23	
Calculated injection volume	cm <sup>3</sup>	12084	13872	15783	19293	18598	20996	24864	18598	20996	24864	28224	32987	39914	38013	45996	54739	38013	45996	54739	57780	68763	80701	
Shot weight,PS	g	11117	12762	14521	17750	17110	19316	22875	17110	19316	22875	25966	30348	36720	34972	42316	50360	34972	42316	50360	53157	63262	74245	
	oz	392	450	512	626	603	681	807	603	681	807	916	1070	1295	1233	1492	1776	1233	1492	1776	1875	2231	2619	
Injection piston speed	mm/s	96			95	95			95			69		58			58			56				
Injection rate	cm <sup>3</sup> /s	1432	1645	1871	2158	1932	2182	2583	1932	2182	2583	1856	2170	2626	1822	2205	2625	1822	2205	2625	2138	2545	2987	
	g/s	1318	1513	1722	1985	1778	2007	2377	1778	2007	2377	1708	1996	2416	1677	2029	2415	1677	2029	2415	1968	2342	2748	
Injection pressure*	MPa	213	186	164	142	198	175	148	198	175	148	206	176	146	210	174	146	210	174	146	208	174	148	
Screw speed	r/min	84			84	69			69			60		54			54			50				
<b>Clamping Unit</b>																								
Clamping force	Ton	2347				2755			3061			3571		4082			5102			6939				
	kN	23000				27000			30000			35000		40000			50000			68000				
Size of mould platens(h x v)	mm x mm	2560X2360				2700X2500			2840X12640			3120X2820		3340X2940			3820X3420			4350X3750				
Clearance between tie bars (h x v)	mm x mm	1820X1620				1920X1720			2020X1820			2220X1920		2420X2020			2800X2400			3200X2600				
Opening stroke	mm	2720/1800				2920/1900			3020/2000			3180/2160		3480/2360			3680/2460			4200/2900				
Mould height min.	mm	780				780			880			980		980			1080			1200				
Mould height max.	mm	1700				1800			1900			2000		2100			2300			2500				
Max. daylight	mm	3500				3700			3900			4160		4460			4760			5400				
Ejector stroke	mm	450				500			500			550		550			550			1000				
Ejector force forward	kN	465				465			465			465		619			619			891				
Ejector force backward	kN	310				310			310			310		420			420			616				
Number of ejector rods	PC	25				29			29			33		33			33			33				
<b>Driving and Heating</b>																								
Installed heating power	kW	109	123	128	145	128	158	173	128	158	173	173	216	236	216	236	263	216	236	263	236	263	290	
Drive power	kW	50+50+50+50			50+50+50+50			50+50+50+50+50			50+50+50+50+50			50+50+50+50+50			50+50+50+50+50			42+50+50+50+50+50				
Working pressure	MPa	17.5			17.5			17.5			17.5		17.5			17.5			17.5			17.5		
<b>Other</b>																								
Oil tank capacity	L	3000			3000			3200			3200			3500		3500			3500			3800		
Maximum mould weight	kg	50000			50000			68000			72000			80000		100000			100000			180000		
Net weight	ton	120			125			135			155			195		254			330			420		
Machine dimensions (LxWxH)	m x m x m	15X4.1X3.6			15X4.1X3.6			15.5X4.3X4.1			16.5X4.5X4.2			19.5X4.9X4.7		20.5X5.2X5.0			23.5X5.3X5.0			25.5X5.8X5.3		

Due to the continuous product improvement, we reserve the right to adjust the individual parameters, without notice.  
\*1 MPa is equivalent to 10 Bar

Due to the continuous product improvement, we reserve the right to adjust the individual parameters, without notice.  
\*1 MPa is equivalent to 10 Bar



# Injection Molding Machine

## DK Series Two Platen- Machine & Platen Dimensions

嘉汇工业机械有限公司  
Jiahui Industrial Machinery Co., Ltd.

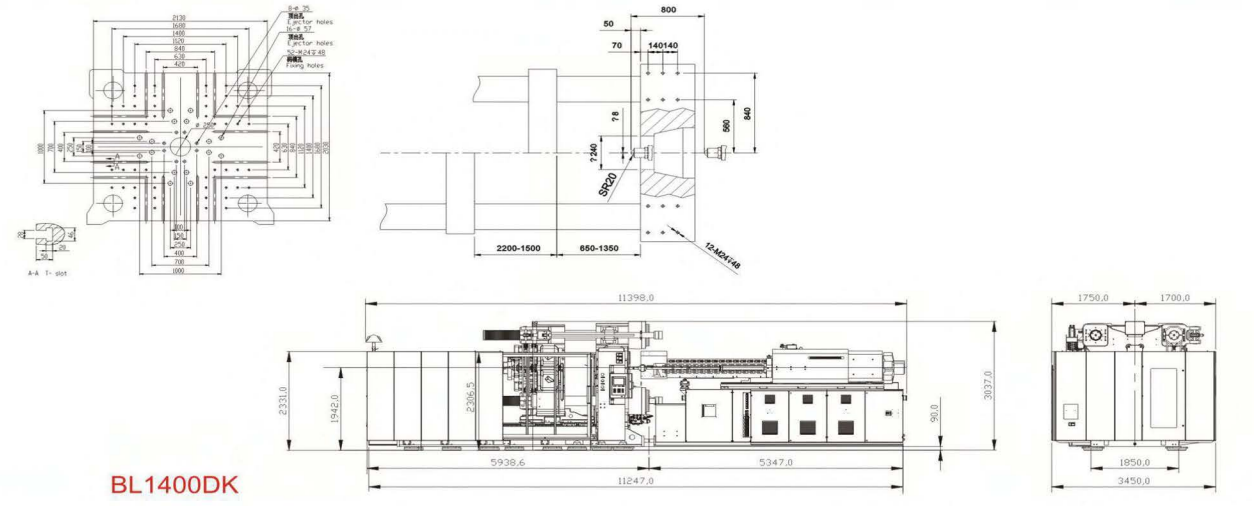
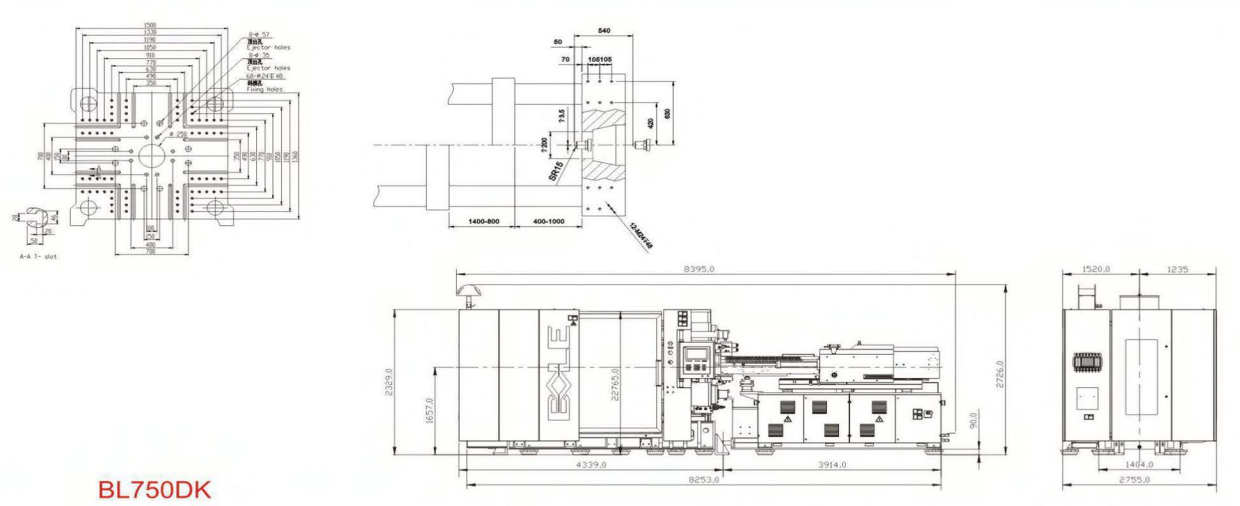
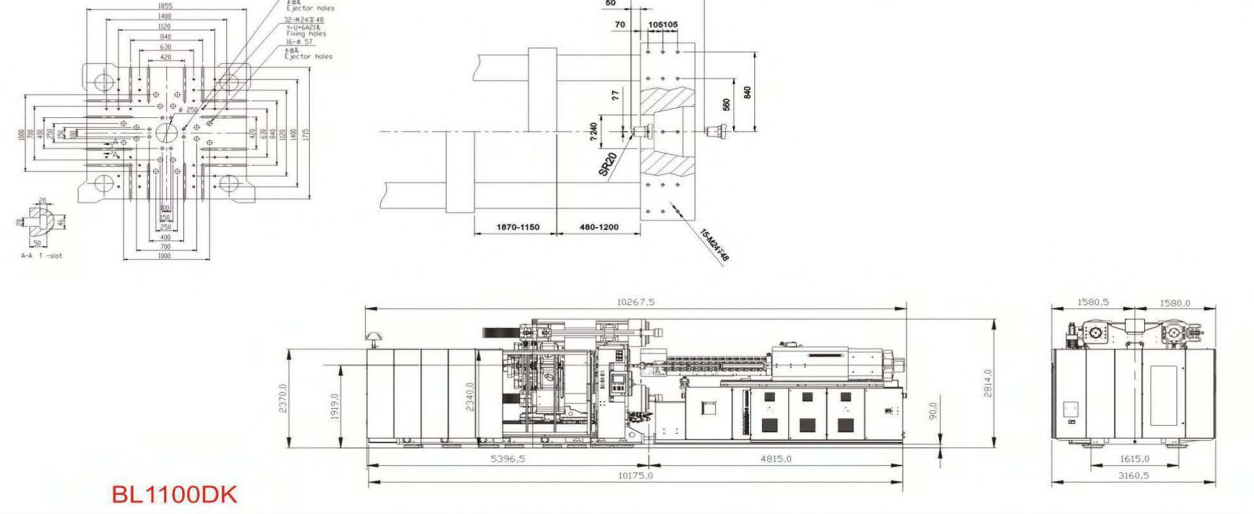
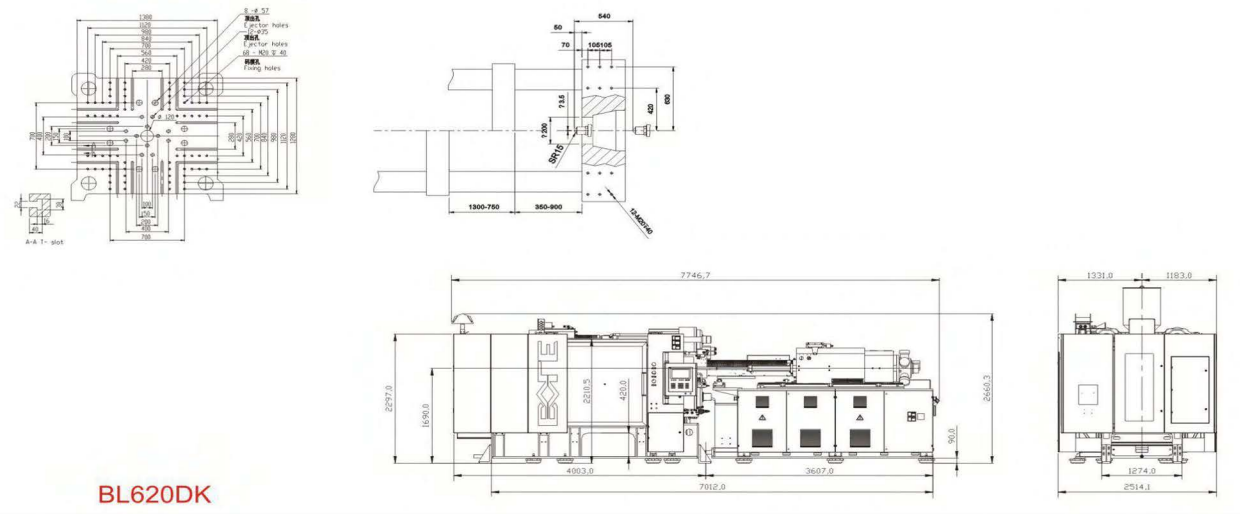
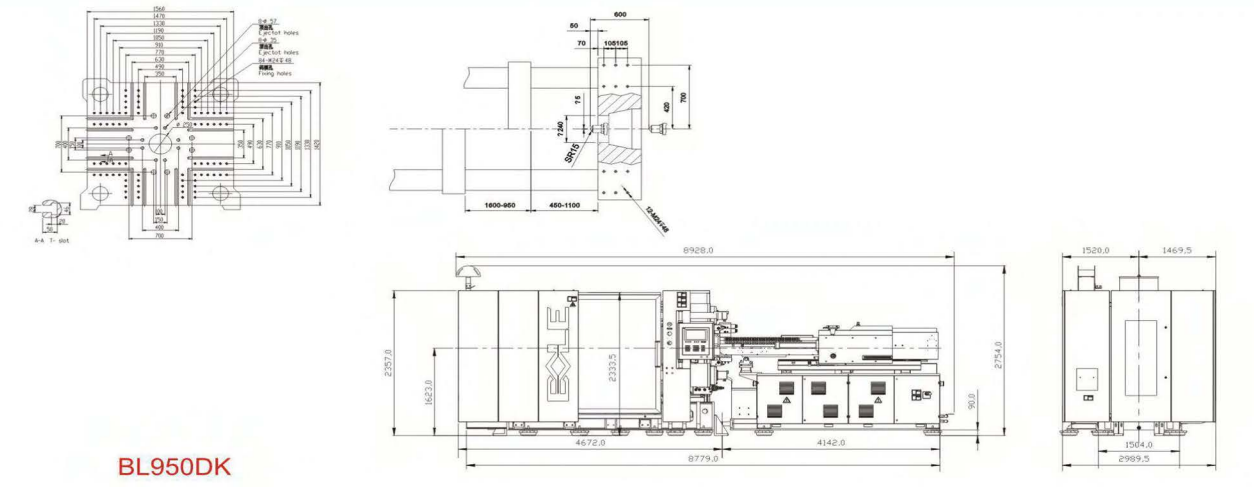
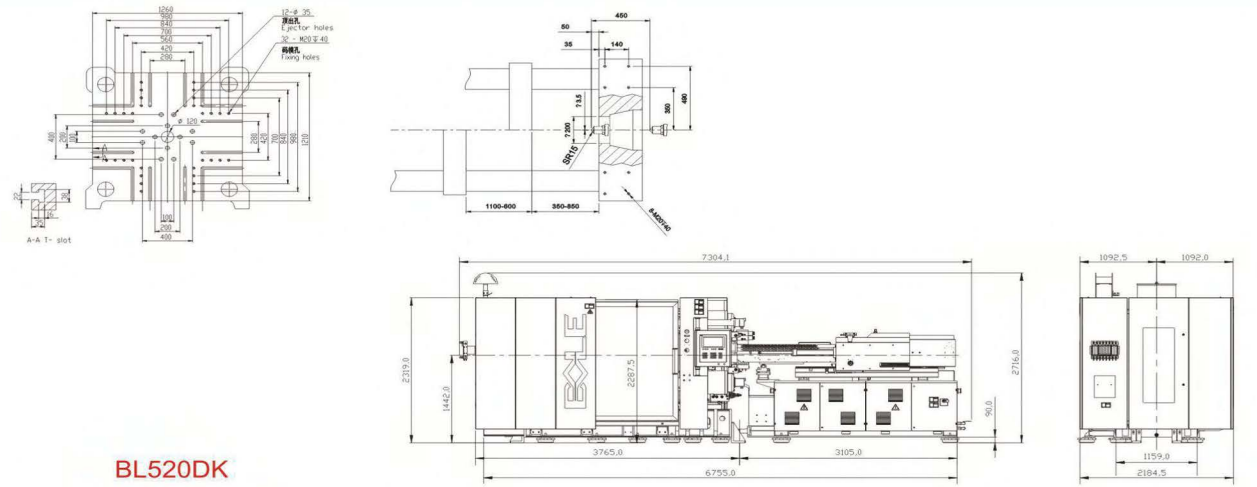



# Injection Molding Machine

## DK Series Two Platen- Machine & Platen Dimensions

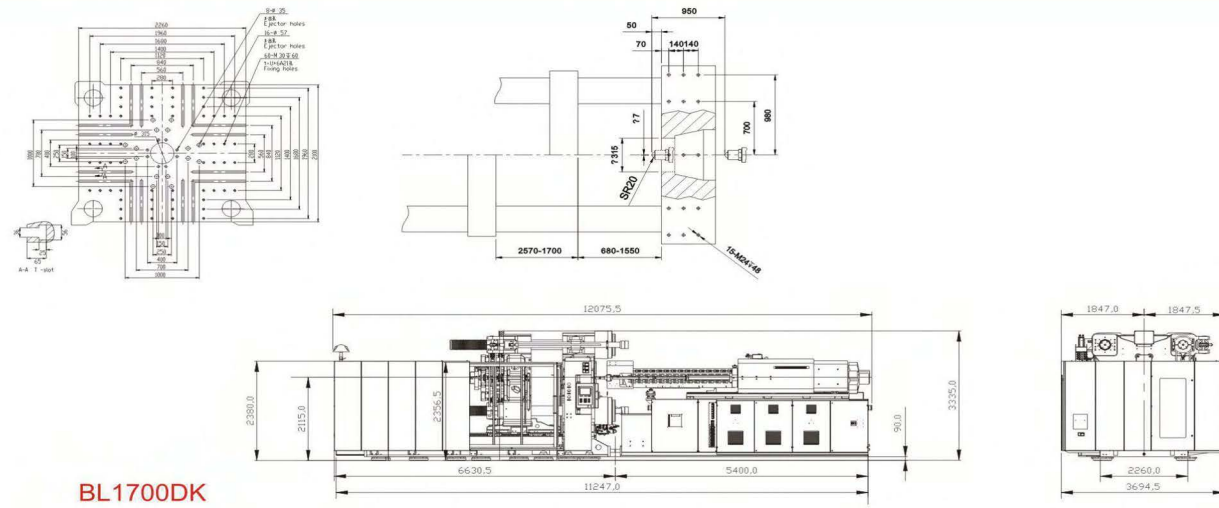

BL1700DK

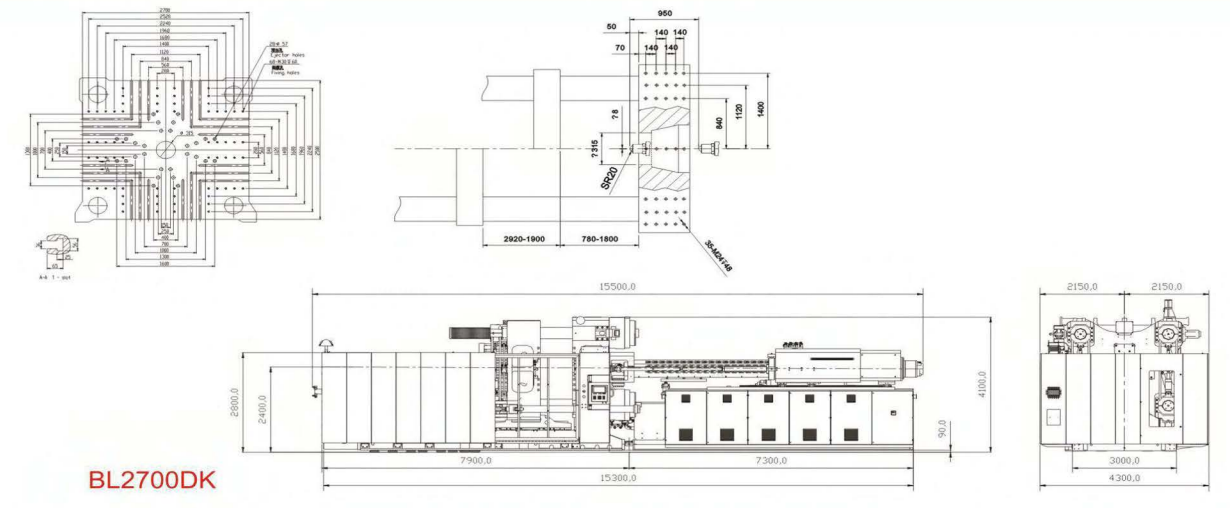

BL2700DK

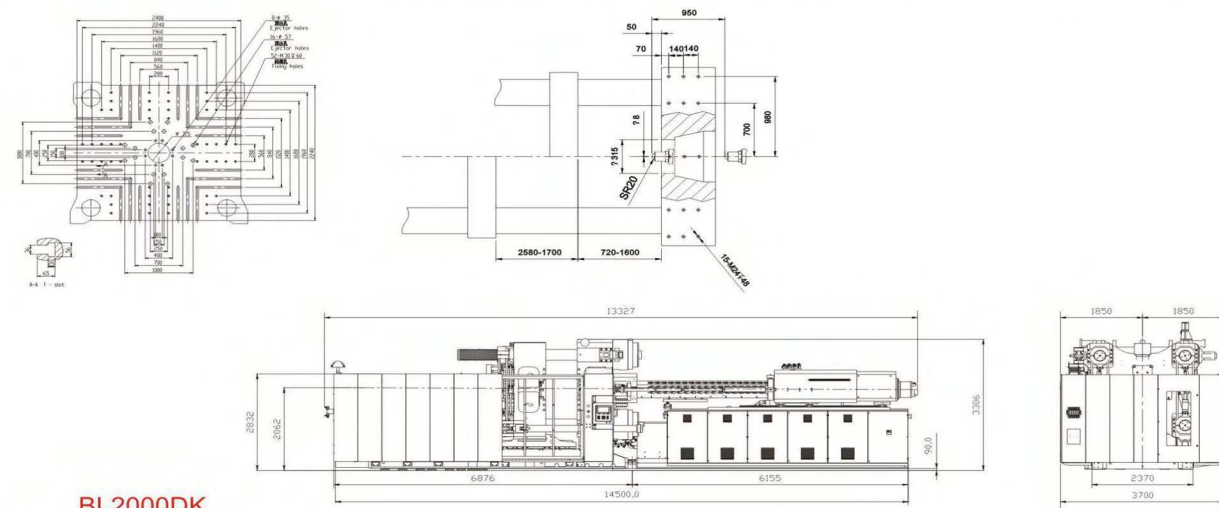

BL2000DK

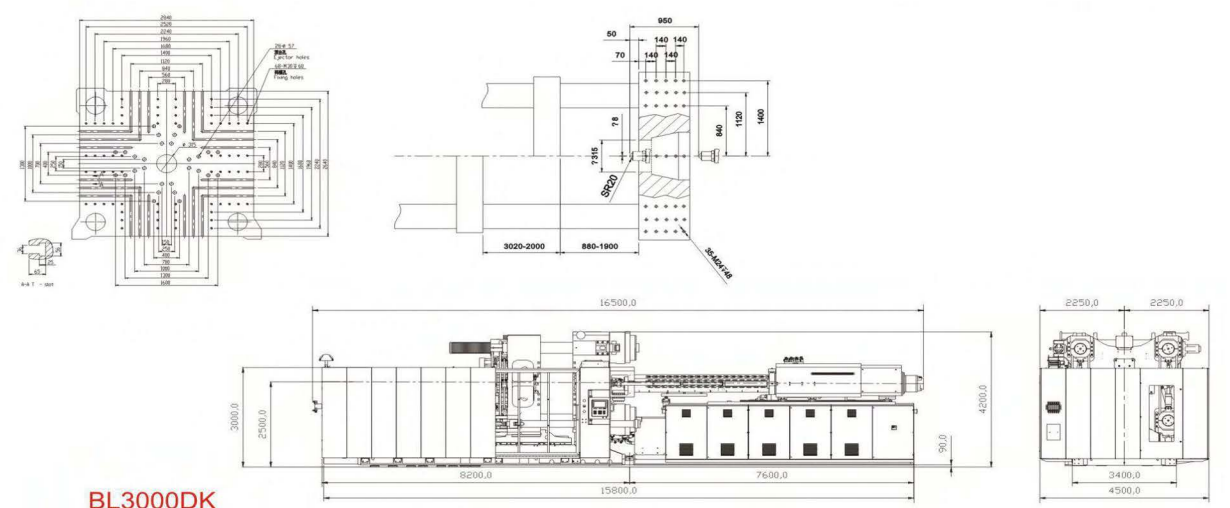

BL3000DK

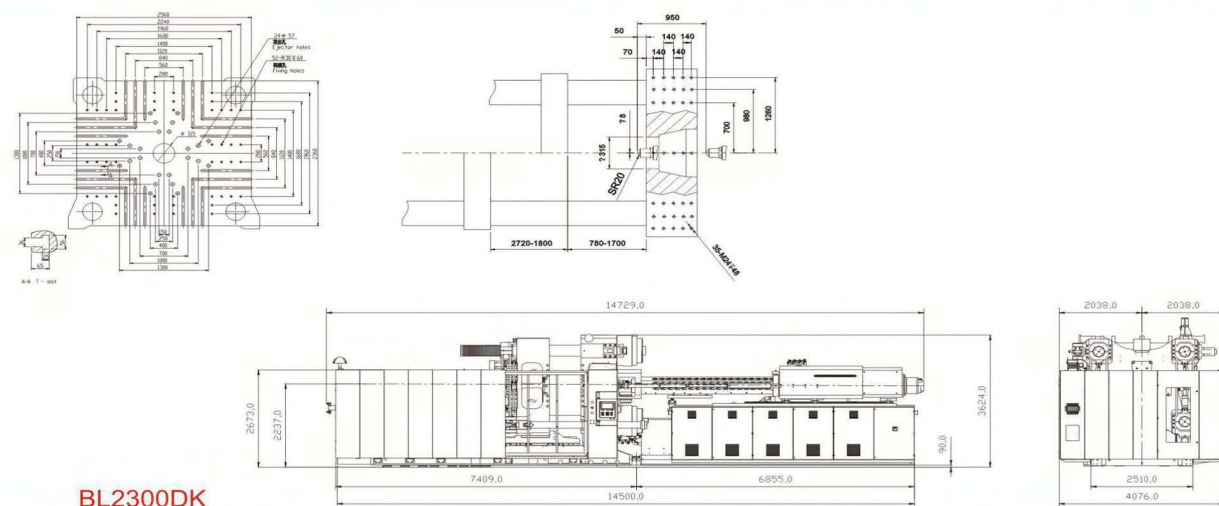

BL2300DK

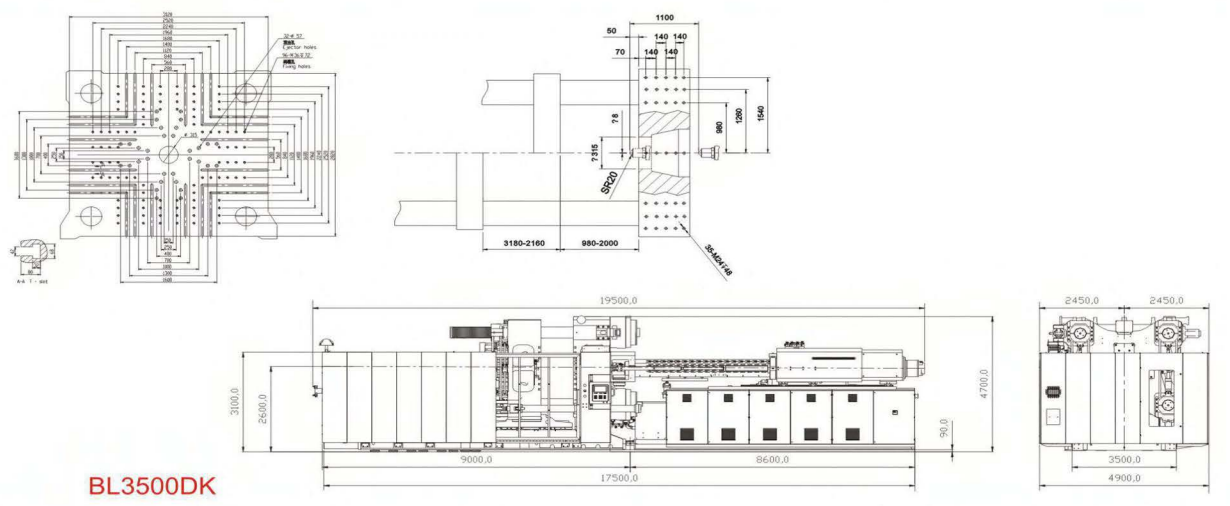

BL3500DK



# CNC LATHE MACHINE

## GLS-150 Series

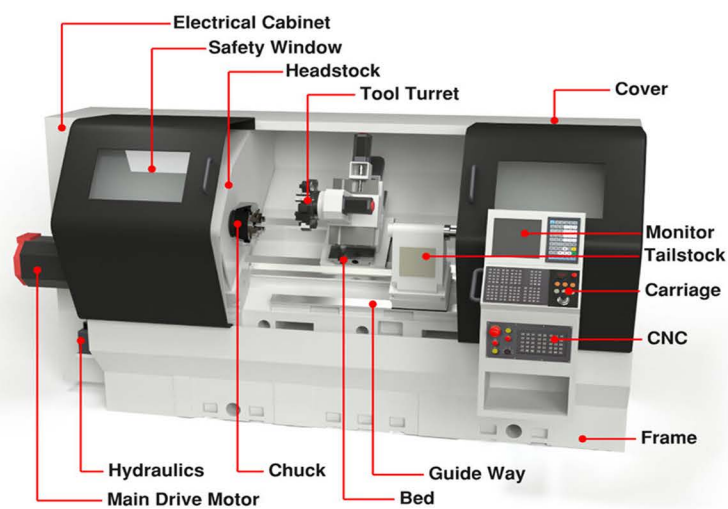

## HIGH SPEED CNC TURNING CENTERS

Packed with industry leading technology and top quality components, the GOODWAY GLS-150 series turning centers combine speed, stability and compact machine size to bring you The Ultimate Machining Power®. These high speed machines will easily accomplish the demanding turning applications of today and tomorrow. Furthermore, with optional live tooling, C-axis, and Y-axis, milling, turning applications can be completed in one single machine.

- ▶ GLS-150 series designs for optimal performance of the latest machining needs, motor power and structure rigidity are highly increased.
- ▶ High precision linear guide way design is used in X & Z axes to provide the optimum control and efficient movement. Rapids are up to 30 m/min.
- ▶ Fully enclosed splashguards keep chips and coolant contained for a safe clean working environment.
- ▶ The auto lubrication system delivers metered amounts of lubrication to the slide ways, ball screws, and vital components. Distribution is automatically shut-off during idling to prevent waste.

SERIES	GLS-150	GLS-200
Chuck Size	6"	8"
Bar Capacity	Ø51 mm (2")	Ø65 mm (2.55")
Max. Turning Length <sup>1</sup>	500 mm (19.6")	480 mm (18.9")

<sup>1</sup> Individual models may vary, detail specification please see work range diagram.



(GLS-200 model shown with optional accessories.)



## MACHINING PERFORMANCE

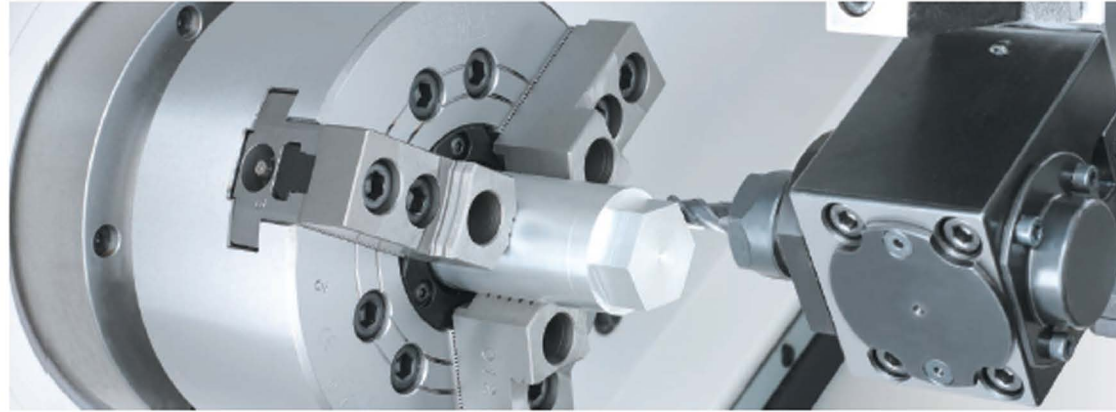

### Machining Capability

Tools	Spindle Speed (rpm)	Feedrate (mm/min.)	Cutting Speed (m/min.)	Cutting Depth (mm)
Drill	Ø15 HSS 1,225	183	50	N/A
End mill	Ø14 HSS end drill 680	108	N/A	15
Tapping	M12 400	700	12	N/A

Material : S45C Testing Model : GLS-150 M

### Live Tooling Turret Specification

Drive Motor Power	2.5 kW (3.3 HP)
Drive Motor	FANUC α8 / 4000 α
Max. Tapping Capacity	M8 × P1.25
Max. Milling Capacity	Ø12 × 10
Gear Ratio	1 : 1

GOODWAY Multi-tasking machine can perform the functions below in one setup:



### Sample Work-Pieces



## GENERAL DIMENSION

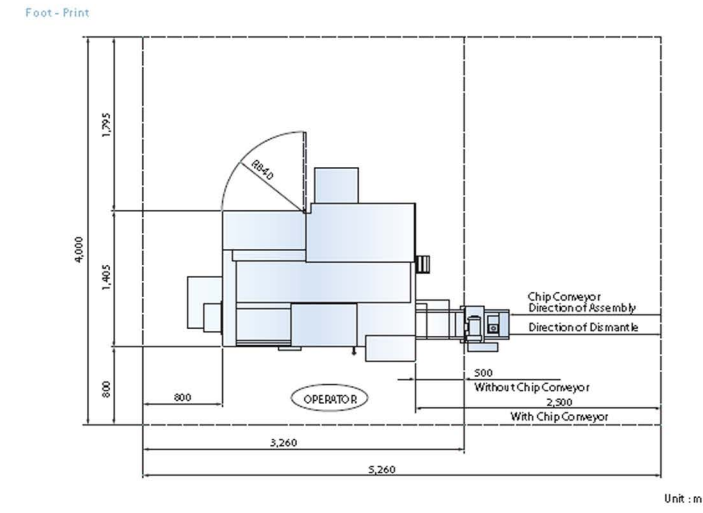

### Machine Layout

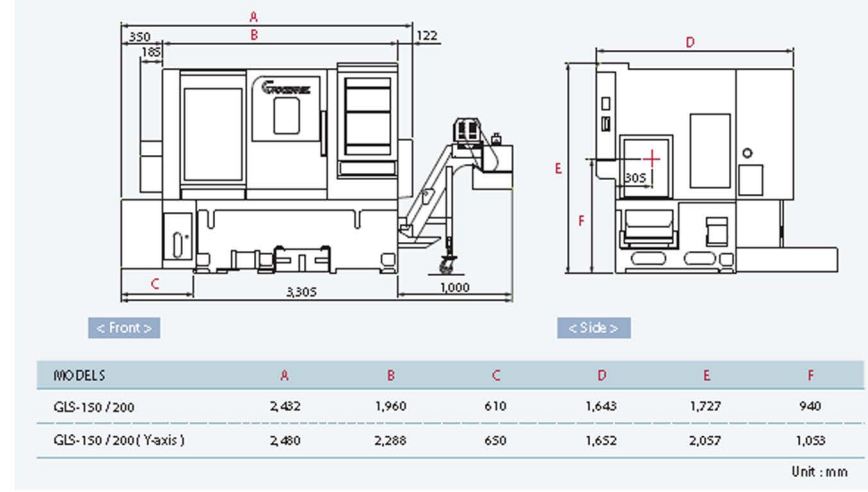

## MACHINE SPECIFICATIONS

	GLS-150	GLS-200
<b>CAPACITY</b>		
Max. swing diameter	Ø 500 mm	Ø 500 mm
19.68" Swing over saddle	Ø 310 mm	Ø 310 mm
12.2"		
Max. turning diameter*1	Ø 360 / 250 mm*2 14.17" / 9.84"	14.17" / 9.84"
9.84" Standard turning diameter*1	Ø 185 mm 7.28"	7.28"
Max. turning length*1	500 mm	500 mm
19.68" Max. weight load*3	85 kg	85 kg
187 lb		
Chuck size	6"	8"
Bar capacity	Ø 51 mm 2"	Ø 65 mm 2.55"
<b>SPINDLE</b>		
Hole through spindle	Ø 61 mm 2.4"	Ø 76 mm
2.9" Spindle bearing diameter	Ø 90 mm 3.54"	Ø 110 mm
4.33" Hydraulic cylinder	8"	10"
Spindle nose	A2-5	A2-6
Motor output (Cont.)	11 kW 15	15 kW 20
HP Motor output (30 min.)	15 kW 20	20 kW 27
HP Motor full output speed	750	750
rpm Spindle drive system	Direct Belt	Direct Belt
Drive		
Spindle drive ratio	1 : 1 (Opt. 211 : 151)	1 : 1 (Opt. 211 : 151)
171 Spindle speed range	60 ~ 6,000 rpm	45 ~ 4,500
rpm Spindle full output speed	750 rpm	750 rpm
<b>BUILT-IN SPINDLE MOTOR (OPTIONAL)</b>		
Motor output (Cont.)	5.5 kW 7.4 HP	7.4 kW 10 HP
Motor output (30 min.)	7.5 kW 10 HP	10 kW 13.4 HP
Bar capacity	Ø 45 mm 1.77"	Ø 45 mm 1.77"
<b>Cs-AXIS SPINDLE (OPTIONAL)</b>		
Cs-axis drive motor	Bz-	
sensor Min. spindle indexing angle		
0.001" Dynamic accuracy	±	
0.02"		
<b>X &amp; Z AXES</b>		
X / Z axes travel*1	210 / 520 mm 8.26" / 20.47"	210 / 520 mm 8.26" / 20.47"
20.47" X / Z axes rapids	30 m/min. 1,181	30 m/min. 1,181
IPM Slide way type	Linear Guide Way	Linear Guide Way
Feed rates	1 ~ 4,800 mm/min. 1 ~ 196.85 in/min.	1 ~ 4,800 mm/min. 1 ~ 196.85 in/min.
189 IPM X / Z axes servo motor	AC 2.7 kW 3.6 HP	AC 2.7 kW 3.6 HP
X / Z axes ball screw Ø / pitch	Ø 32 mm 1.25" / Pitch 10	Ø 32 mm 1.25" / Pitch 10
X / Z axes thrust (Cont.)	769 kg 1,695 lb	769 kg 1,695 lb
<b>TURRET</b>		
Stations	12 / 10	12 / 10
Indexing drive	FANUC AC Servo motor	FANUC AC Servo motor
Indexing speed	0.2 sec. Adjacent / 0.5 sec. 180 degrees (Single step) Accuracy	0.2 sec. Adjacent / 0.5 sec. 180 degrees (Single step) Accuracy
Positioning : ± 0.00089", Repeatability : ± 0.00027" O.D. tool shank size	± 0.00089", Repeatability : ± 0.00027" O.D. tool shank size	± 0.00089", Repeatability : ± 0.00027" O.D. tool shank size

### Foundation

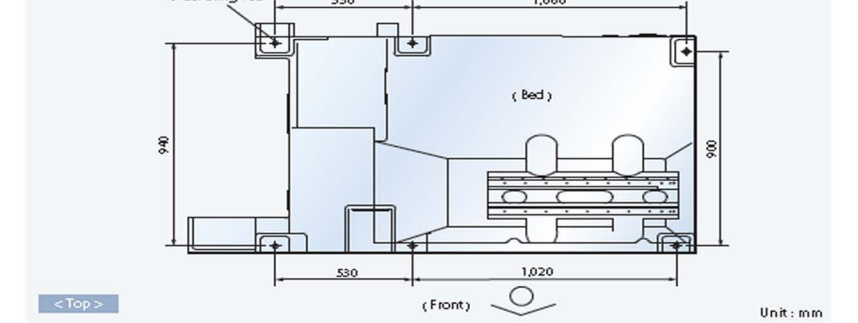



# CNC MILLING MACHINE

## EV Series

嘉汇工业机械有限公司  
Jiahui Industrial Machinery Co., Ltd.



### Product Description

#### 1. Product Introduction

EV Series has high performance, high efficiency, high precision, high stability. The machine can realize the functions of the vast majority of drilling, milling, boring and reaming automatic processing cycle. It is ideal for light industry, textile machinery, mold industry and spare parts processing equipment.

#### 2. Main features

1. "A" type column has bigger span in base to ensure rigidity and stability
2. In spindle box, rib is reinforced to strengthen the contact surface between spindle box and column and provides great support.
3. All the parts are Germany, Japan and Taiwan imported components to ensure the durability and long-term stability of machine.

- Milling Cutter Type: Vertical Milling Cutter
- Automatic Grade: Automatic
- Precision: High Precision
- Type: Tool Milling Machine
- Processing Type: Metal
- X,Y,Z Motor Type: Servo Motor
- Warranty: 1 Year
- HS Code: 84571010
- Positioning precision:  $\pm 0.005\text{mm}$  JIS
- Repeatability positioning precision:  $\pm 0.0025\text{mm}$  JIS





# CNC MILLING MACHINE

## EV Series

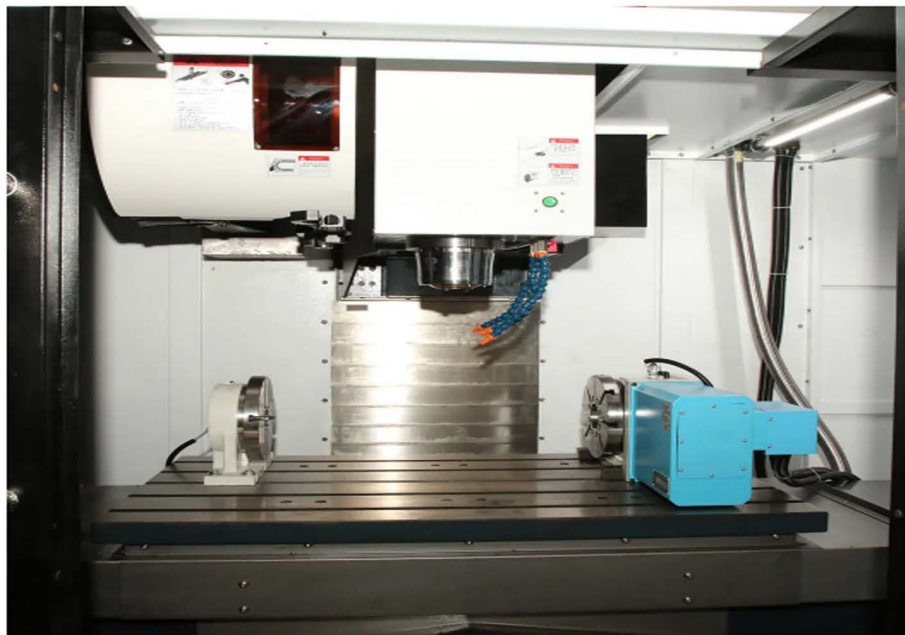

Technical Parameters all kinds of size for your reference

Item	Unit	EV640L	EV850L/M	EV1060L/M	EV1165L	EV1270L/M	EV1370L	EV1580	EV1890	
X/Y/Z-axis travel	mm	600/400/450	800/500/500	1000/600/600	1100/650/600	1200/700/700	1300/750/700	1500/800/700	1800/900/800	
Table size	mm	420*700	500*1050	600*1300	660*1200	700*1360	700*1400	800*1700	900*2000	
Max.Table load	KG	350	600	1000	1000	1400	1400	2000	2000	
BT-Type		BT40			BT40/50		BT50(OPBT40)			
Spindle max.Speed	Rpm	12000	Belt type 10000 (op 12000/15000)					6000		
Spindle power	KW	5.5/7.5	7.5/11	7.5/11(op11/15)			11/15(op15/18.5)			
Cutting feed rate	mm/min	0-20000	0-10000					0-8000		
Rapid feed rate	M/min	48*48*36	L:48*48*36 M:20*20*15	L:36*36*30 M:20*20*15	L:36*36*30	L:30*30*24 M:20*20*15	30*30*24	X/Y:16 Z:14	X/Y:16 Z:14	
Net weight	KG	4500	5800	6500	6800	7500	8000	12000	15500	
NC System		MITSUBISHI M80B / Siemens 828D / FANUC OIMF					Economical :EV640LE/850LE GSK25I)			





# POWDER COATING LINE

Metal Products Autoamtic Powder Coating Line

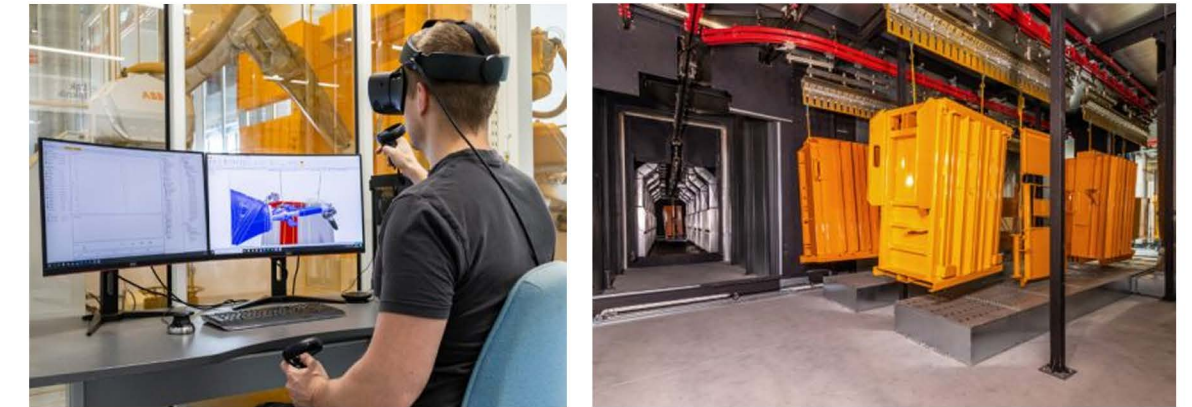
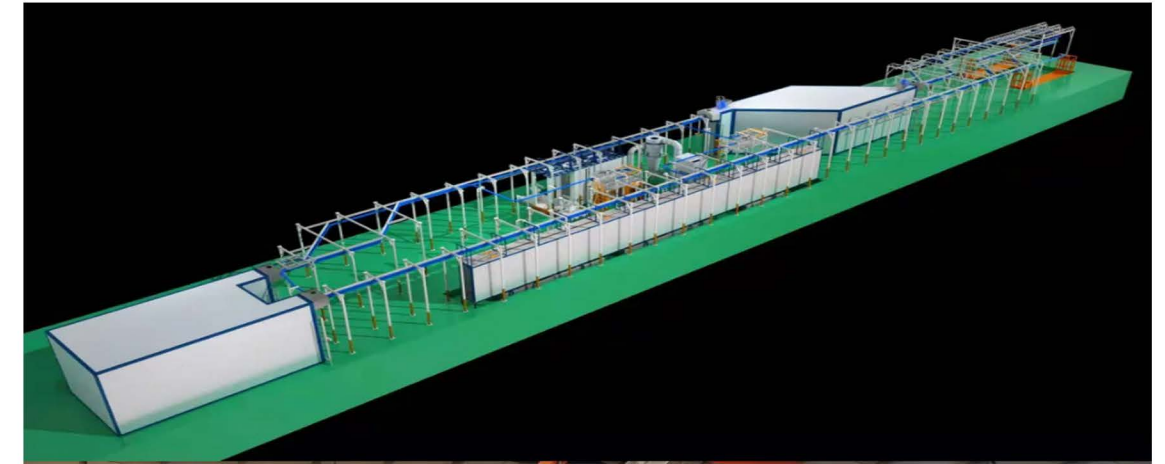

There is a vast range of equipment and machines to choose from when putting together fully integrated surface treatment plants. For the most part this includes:  
 equipment for preliminary surface treatment,  
 paint booths for applying liquid coatings,  
 plastic powder spray booths,  
 drying and curing ovens,  
 machinery for transport and handling,  
 application systems,  
 special single-purpose machines,  
 complete system of managemetn and visualization of the technological process.

Equipment	Application
Pre-treatment System	Clean the work piece surface before powder coating, there is the spray pretreatment and dipping tank system and so on
Powder Coating Booth	Anti-static plastic board
Cyclone System	Better Powder Recovery
Conveyor System	Different design according to different weight products
Curing Oven	Curing of Plastic Powder
Electrical Control System	Famous Brand



# ASSEMBLY WORKSTATIONS

Customized Size Aluminum Profile Workstation for Assembly Line

嘉汇工业机械有限公司

Jiahui Industrial Machinery Co., Ltd.



嘉辉实业  
JIAHUI INDUSTRIAL



We can customize any style and size according to the requirements of our customers. Meet the different needs of different industries.



<b>Product Description</b>	Standard T slot & V slot aluminum profile
<b>Material</b>	Building & Construction, Transportation, Electrical & Energy, Machinery, Radia profiles for LED cooling, Non-standard Automation, Structure Framing, etc
<b>The Option of Profile</b>	15/20/25/30/40/45/50/60/80/90/100/160 series
<b>Material Analysis</b>	99.9% Aluminium Alloy 6063 T5
<b>Color</b>	Standard: black, silver and grey, can be customized (RAL color numbers)
<b>Surface Treatment</b>	Mill finish, Anodizing, Sand Blasting, Powder coating, etc.
<b>Deep Processing</b>	Cutting Size, Drilling holes, Adding mounting bracket, Flanged side panels, etc.
<b>Quality Guarantee</b>	20 Years Quality Guarantee
<b>Certification</b>	ISO9001

### The Advantage of Using LE Standard Aluminum Profile:

1. Saving mold cost and shorten production time.
2. Shorting design and assembling time.
3. Associated accessories are available as well to save your time to resource it.
4. Controlling cost and providing more efficient working project.
5. Improving your systems and space management with our professional technical team.



# ASSEMBLY WORKSTATIONS

## Features and Specifications



**Anti-static Work Surface**  
Anti-static table top is made of 18mm solid wood pressure plate, 2mm anti-static rubber, total thickness is 20mm, black rubber edge is wrapped, beautiful, strong bearing capacity, simple installation, durable

**Solid Wood Workbench**  
Anti-static countertop with 18mm solid wood pressure plate countertop. Strong bearing capacity. Smooth installation Easy and durable

**Fixed Foot**  
With support, shockproof, etc., the screw can adjust the height

嘉汇工业机械有限公司

Jiahui Industrial Machinery Co., Ltd.



嘉辉实业  
JIAHUI INDUSTRIAL

**Anti-static Work Surface**  
Anti-static table top is made of 18mm solid wood pressure plate, 2mm anti-static rubber, total thickness is 20mm, black rubber edge is wrapped, beautiful, strong bearing capacity, simple installation, durable

**Solid Wood Workbench**  
Anti-static countertop with 18mm solid wood pressure plate countertop. Strong bearing capacity. Smooth installation Easy and durable

**Fixed Foot**  
With support, shockproof, etc., the screw can adjust the height

### Function and Connecting Detail:

1. Cutting the size of aluminum profile with designed.
2. Select suitable accessories to connecting the aluminum profile for the kits.
3. Langle can help select to the accessories if you are not clear which size to use.
4. And if you are the new of using aluminum profile, just tell us the function of the kit you want to build, so we can recommend the suitable size of materials to use and also provide the design service.





# QUALITY CONTROL EQUIPMENT

## Coordinate Measuring Machine

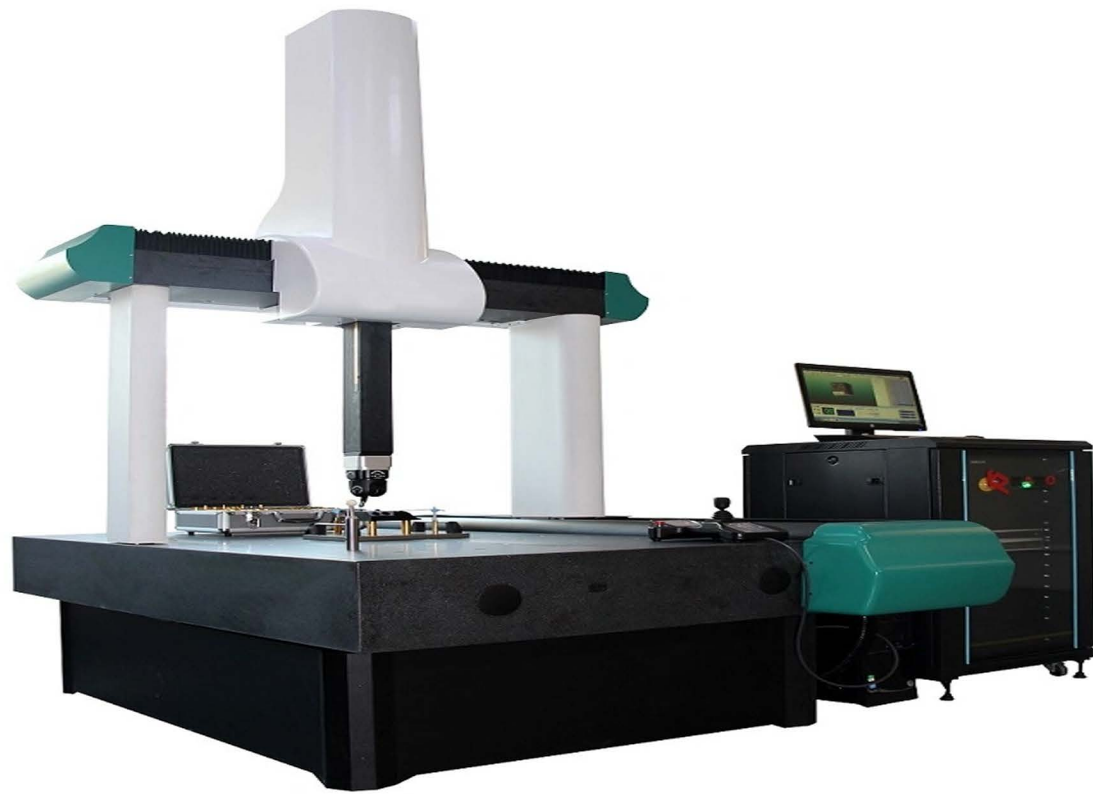

### Product Description

Adoption of integrated granite-material guide ways makes sure of stable thermal performance of themselves.

The totally enclosed surrounding guide way structure makes measuring more accurate. 21 terms of compensation technique as to mechanical geometric errors improve the machine's precision greatly.

Three axis's adoption of quiescent air pressure air-bearing guide way, comprised of air-bearings which are self-swaps, small resistance, no abrasion and stable motion.

Unenclosed structure leads to various measurement configuration solutions. Therefore, measurement experience gets so flexible.

Adoption of advanced F.E.M(finite element method) makes it have a stable and reliable resistance of effective deformation.

### SPECIFICATIONS

Range of Trips(Mm)			Dimensions(mm)			Main Machine Weight (Kg)	Max. Weight of Workpiece to Be Measured (Kg)
X	Y	Z	Lx	Ly	Lz		
600	800	600	1150	1735	2630	730	300
Accuracy Index: According to GB/T 16857.2-2006 (equivalent to ISO 10360-2:2001) CMM Performance Evaluation Standard.							
<b>MPEE(um)</b>				<b>MPEP(um)</b>			
2.6 + L/300				3.5			
<b>Dynamic performance</b>							
<b>3D(mm/s)</b>				<b>3D(mm/s<sup>2</sup>)</b>			
520				1730			



# QUALITY CONTROL EQUIPMENT

## Surface Roughness Tester



### Measuring Range

Parameter	Range
Ra,Rq	0.005μm ~ 30μm
Rz,R3z,Ry,Rt,Rp,Rm	0.02μm ~ 320μm
Sk	0 ~ 100%
S,Sm	1mm
tp	0 ~ 100%



### Technical Specification:

Measurement Range	The Z axis (vertical)	±80μm/±160 μm(enhanced model)
	The X axis (Transverse)	17.5mm
Resolution	The Z axis (vertical)	0.01μm/±20μm
		0.02μm/±40μm
		0.04μm/±80μm
		0.08μm/±160μm
Measurement item	Parameter	Ra, Rz, Rq, Rt, Rp, Rv, R3z, R3y, Rz(JIS), Rs, Rsk, Rsm, Rku, Rmr, Ry(JIS), <b>Rmax, R<sub>Pc</sub>, Rk, Rpk, Rvk, Mr1, Mr2</b>
	Standard	ISO, ANSI, DIN, JIS
	Graphic	Bearing area curve, Roughness profile, Primary profile
Filter		RC, PC-RC, Gauss, D-P
The sampling length( <i>lr</i> )		0.25, 0.8, 2.5mm
Assessment length( <i>ln</i> )		$L_n = l_r \times n$ $n=1\sim5$
Sensor	Measuring method	skidded
	Stylus tip	Diamond, 90 cone angle, 5μmR
	Force	<4mN
	Skid part	Hard Alloy, Skid Radius of curvature: 40mm
	Traversing speed	$l_r=0.25, V_t=0.135\text{mm/s}$
$l_r=0.8, V_t=0.5\text{mm/s}$		
$l_r=2.5, V_t=1\text{mm/s}$		
Return $V_t=1\text{mm/s}$		
Accuracy		Less than ±10%
Repeatability		Less than 6%
Power supply		Built-in Lithium ion battery, Charger :DC5V,3200mA
Outline dimension		Main unit: 52*55*158mm drive: 23*27*115mm
Weight (main unit)		Around 400g
working Environment		Temperature: - 20°C ~ 40°C Humidity: < 90% RH
Store and Transportation		Temperature: - 40°C ~ 60°C Humidity: < 90% RH



# MATERIAL HANDLING EQUIPMENT

## Forklifts, Pallet Jacks



The Four-Wheel Electric Forklift with Zero-Emission, Zero-Pollution, Low-Level Vibration, Low-Level Vibration, Low Operation Cost, High Efficiency, High Quality.



Specification	1	Brand	JIAHUI				
	2	Model	FB20	FB25	FB20N	FB25N	
	3	Rated Load Capacity	Q(kg)	2000	2500	2000	2500
	4	Load Centre	C(mm)	500			
	5	Lift Height	H3(mm)	3000			
	6	Free Lift	H2(mm)	100			
	7	Fork Size (L×W×T)	L/W/T(mm)	1070×120×40			
	8	F/B( $\alpha^\circ/\beta^\circ$ )	Deg	6°/12°			

### Heavy Duty Hand Pallet Truck

Product code	HP 50	
Capacity	kg	5000
Fork dimensions	mm	160 x 60 x 1220
Wheel type	mm	nylon / polyurethane
Load wheel size	mm	Ø80 x 70
Steering wheel size	mm	Ø200 x 50
Min. fork height	mm	85
Max. fork height	mm	200
Overall length	mm	1605
Overall width	mm	685
Overall height	mm	1226
Packing size	cm	225 x 69 x 67 / 6pcs
Net weight	kg	160







# 嘉汇工业机械有限公司

**Jiahui Industrial Machinery Co., Ltd.**

Address: No. 2587, Zhangjiang Hi-Tech Park, Pudong New Area, Shanghai, China

Web: [www.toolmaking.info](http://www.toolmaking.info)

Email: [Sales@toolmaking.info](mailto:Sales@toolmaking.info)

Tel: +86-13-3219-0032